

GasStop™

Emergency shut-off valve for propane gas cylinders



5 YEAR WARRANTY



GasStop™

Please read & retain the instructions before use.

IMPORTANT!

Before using this product please read and understand the instructions found in this manual. These instructions form an important part of your purchase. These instructions also contain a limitation of our liability for

any loss of damage arising from your use or misuse for any reason. If you do not agree with the limitation detailed inside you should return your GasStop with proof of purchase within 7 days of purchase for a full refund.

SAFE

100% automatic shut-off in the event of a major leak

PRACTICAL

Useful indicator shows you when your gas is running low

EASY

Easy to install, easy to use



Easy to use, easy to install

Important: The gas level indicator will give you a more accurate reading after 10 minutes of use.

● High pressure ● Enough gas ● Refill soon

GASSTOP™ EMERGENCY SHUT-OFF VALVE

UK-POL (G.7) - GSUK1 - LPG

USER INSTRUCTIONS

© Gas Stop Europe BV | A356300-D-002 | EN

TECHNICAL DATA

Unit Code	Connector Type	Marine Use	Supply Pressure (P)	Guaranteed Capacity / Flow (m³/h)	Max Residual Flow (Q)
GSUK1	Screw-Type	No	0.6 - 16 bar	1 - 1.5 kg/h	15 - 200 cm³/h
Inlet Connector	Outlet Connector	Recommended Tightening Torque	Gas Type	Operating Temperature	Valve Shut-Off
UK POL LH (G.7)	UK POL LH (G.7)	20 Nm	Propane LPG	-20°C to 50°C	≥110% m³ (in event of major leak)

Technical data subject to changes
NB. Technical data specific to individual 'Unit Code'

QUALITY STANDARDS

EN 15202:2012, EN 16129:2013, EN 549:1995, CGA V-1 2013, ISO 16964:2015. Manufacturers ISO 9001:2008 certified.

INTENDED USE

GasStop™ is a major leak emergency shut-off valve for use on LPG cylinders only. All national LPG regulations must be observed prior to use.

GasStop must always be used with a pressure regulator. The pressure regulator must be rated no higher than 50 mbar. GasStop must only be used on LPG cylinders with a permissible inlet pressure range of 0.6 – 16 bar. GasStop must not be used in conjunction with an Excess Flow Valve (EFV).

The direction of intended gas flow is clearly marked on each GasStop unit (manufactured 2018 onwards). Use of GasStop on marine boats or within EX Zone 0 is prohibited.

USER INSTRUCTIONS - GASSTOP™ EMERGENCY SHUT-OFF VALVE

Keep these user instructions in a safe place for future reference. Please read these instructions fully before use. If you are unsure about anything, please do not use the product and contact either a qualified gas specialist or Gas Stop Europe BV directly.

CONTENTS

A. SAFETY	E. AUTOMATIC SHUT-OFF MECHANISM
B. INSTALLATION	F. FAQ
B.1. SCREW-TYPE DEVICES	G. USEFUL TIPS
B.2. QUICK COUPLING DEVICES	H. CONTACT
C. CHECKING SYSTEM FOR LEAKS	I. WARRANTY
D. READING THE GAS PRESSURE GAUGE	

SYMBOLS USED

SYMBOL	DEFINITION
⚠	Possible hazard. Be vigilant.
i	Useful information and tips.
🔌	Contact a certified gas professional or Gas Stop Europe BV directly.

A. SAFETY

⚠ Important. GasStop may only be installed by adults who have read and understood these instructions fully.

- Only install and use GasStop in a well-ventilated area.
- GasStop must only ever be installed directly onto the gas cylinder.
- GasStop is not designed to shut-off in the event of minor leaks. GasStop is designed to shut-off in the event of a major leak only.
- Carry out prior checks on all GasStop rubber seals and components before installation, checking for damage and wear. If any rubber seals are missing, do not use GasStop.
- Carry out prior checks on the gas cylinder, pressure regulator, hose and all other components on your gas system. Check for damage and wear, do not use the system if there is any damage or excessive wear.
- Ensure GasStop is appropriate for use on the intended gas system, referring to the *Technical Data table at the top of these instructions for compatibility information* ('Inlet Connector', 'Outlet Connector', 'Gas Type', 'Supply Pressure' and 'Guaranteed Capacity').
- GasStop is not to be used with pressure regulators with set pressures over 50 mbar. GasStop is for low pressure use only. The set pressure of the regulator (e.g. 27 mbar, 30 mbar, 37 mbar, 50 mbar etc.) should be clearly labelled on the regulator.
- Do not install or uninstall GasStop near any form of naked flame (minimum distance: 10 metre radius). In addition to this, make sure that no one is smoking, using a mobile telephone, or operating an ignition source in the vicinity. During gas use, remain vigilant, keep your gas cylinder and GasStop a safe distance away from any naked flame (minimum distance: 60 centimetre radius).

⚠ Important. Residual gas! Never install or uninstall your gas system near a naked flame. Smoking is strictly prohibited!

- Do not use GasStop if there is a risk of product damage caused by: heat, vibrations, corrosion, water or chemicals.
- Do not use a GasStop in conjunction with an excess flow valve (EFV).
- In accordance with EN 16129:2013, in normal conditions of use, in order to ensure correct operation of the installation, it is recommended that this device is changed within 10 years of the date of manufacture. The date of manufacture is clearly marked on all GasStop units.

B. INSTALLATION

B.1. INSTALLATION (SCREW-TYPE DEVICES)

Screw-type connector examples:

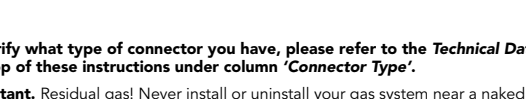

i To verify what type of connector you have, please refer to the Technical Data table at the top of these instructions under column 'Connector Type'.

⚠ Important. Residual gas! Never install or uninstall your gas system near a naked flame. Smoking is strictly prohibited!

1. Tightly turn off the tap on the gas cylinder.
2. Turn off the gas appliance(s).
3. For 'Standard Installations - Screw-Type' (BBQ's, grills, heaters), disconnect the pressure regulator and hose from the gas cylinder (if already connected). For 'Changeover/Bulkhead Installations - Screw-Type' (caravans/RV's/motorhomes), disconnect the hose from the gas cylinder. See diagram (Figure 1. and Figure 2.) below for a visual representation of 'Standard' and 'Changeover/Bulkhead' installations.
4. Check that the rubber seals are present on all connectors.
5. Visually inspect any rubber seals present to check for dirt and damage. Clean or replace if necessary.
6. Connect the GasStop to the gas cylinder outlet valve directly. Note: Most gas connections have a left-handed screw thread (turn anti-clockwise to attach). Left-handed threads are marked as 'LH'. Some gas connections have a right-handed screw thread (turn clockwise to attach). Right-handed threads are marked as 'RH'. Please refer to the Technical Data table at the top of these instructions for individual unit thread information (see 'Inlet Connector' and 'Outlet Connector' for reference).

⚠ Important. GasStop must only ever be installed directly onto the gas cylinder.

7. Firmly hand tighten the GasStop onto the gas bottle.
8. Now tighten the union nut using a gas safe spanner until securely gas tight. Do not over tighten or force any couplings, this may damage the threads. Refer to the Technical Data table for individual device tightening torques ('Recommended Tightening Torque').
9. Never extend vertical or horizontal force on the GasStop or the pressure gauge.
10. For 'Standard Installations - Screw-Type' (BBQ, grills, heaters): connect the pressure regulator, hose and appliance(s) to the GasStop and tighten until gas tight. Do not use a GasStop in conjunction with an excess flow valve (EFV). The pressure regulator used must be rated no higher than 50 mbar and not bear the markings 'EFV'. See diagram below (Figure 1.) for a visual representation of 'Standard Installations - Screw-Type'.
11. For 'Changeover/Bulkhead Installations - Screw-Type' (caravans/RV's/motorhomes): connect the high-pressure hose to the GasStop and tighten until gas tight. Now connect the hose to the changeover/bulkhead device. Do not use a GasStop in conjunction with an excess flow valve (EFV). The pressure regulator used must be rated no higher than 50 mbar and not bear the markings 'EFV'. On changeover/bulkhead installations a GasStop must be installed on each cylinder connected to the changeover/bulkhead. See diagram below (Figure 2.) for a visual representation of 'Changeover/Bulkhead Installations - Screw-Type'.
12. If operating in changeable weather, mount the GasStop at a slight angle to stop rainwater collecting on the pressure gauge. Protect your GasStop from the environment/weather where you can.
13. Your system is now ready to prime. It is highly recommended that all systems are checked for leaks prior to use (see section C. below).
14. To prime the GasStop, turn on the gas cylinder (make sure the cylinder valve/tap is fully open) and pump the gauge 4-6 times. You will now notice gas flowing into the system. If the needle is stable and GasStop has not shut-off you are ready to use your appliance(s) as normal.

⚠ i Important. If the outcome is not as described in point 14. please stop using your gas. Contact a gas specialist before any further use.

15. At the end of any gas use, turn off the appliance(s) and the gas cylinder as normal. Disconnect the hose from your appliance in a well-ventilated area as residual gas may still be in the system.

⚠ Important. Residual gas! Do not disconnect your system near a naked flame (minimum distance: 10 metre radius). Smoking is strictly prohibited!

i See FAQ section below for commonly asked questions.

FIGURE 1. STANDARD INSTALLATIONS - SCREW-TYPE



a = GasStop b = Pressure regulator c = Hose d = Appliance

⚠ i Important. If your installation does not match that of Figure 1. please stop using your gas. Contact Gas Stop Europe BV or a gas specialist before any further use.

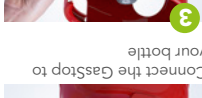
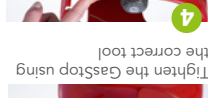

Gas Stop Europe BV
© 2016
Ceresleijn 70
9401 ZG Assen, Netherlands
info@gasstopglobal.com
www.gasstopglobal.com
Design protected by European law
ISO 16964 standards

FIGURE 2. CHANGEOVER/BULKHEAD INSTALLATIONS - SCREW-TYPE

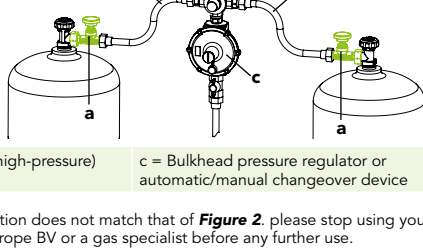

a = GasStop b = Hose (high-pressure) c = Bulkhead pressure regulator or automatic/manual changeover device

⚠️ Important. If your installation does not match that of **Figure 2**, please stop using your gas. Contact Gas Stop Europe BV or a gas specialist before any further use.

B.2. INSTALLATION (QUICK COUPLING DEVICES)

Quick coupling connector examples:

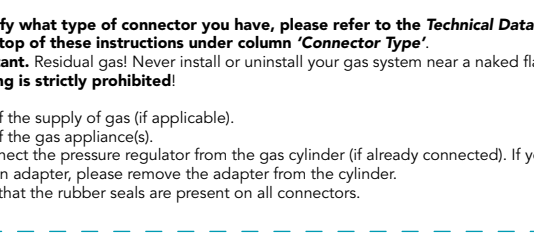

ⓘ To verify what type of connector you have, please refer to the Technical Data table at the top of these instructions under column 'Connector Type'.

⚠️ Important. Residual gas! Never install or uninstall your gas system near a naked flame. **Smoking is strictly prohibited!**

1. Turn off the supply of gas (if applicable).
2. Turn off the gas appliance(s).
3. Disconnect the pressure regulator from the gas cylinder (if already connected). If you are using an adapter, please remove the adapter from the cylinder.
4. Check that the rubber seals are present on all connectors.

⚠️ Important. GasStop must only ever be installed directly onto the gas cylinder.

8. Never exert extreme vertical or horizontal force on the GasStop or the pressure gauge.
9. For 'Standard Installations - Quick Coupling' (BBQ, grills, heaters): connect the pressure regulator (as per the manufacturers instructions) and hose to the GasStop and install so gas tight. Do not use a GasStop in conjunction with an excess flow valve (EFV). The pressure regulator used must be rated no higher than 50 mbar and not bear the markings 'EFV'. If you are using a GasStop Adapter device please refer to point 10. See diagram below (Figure 3) for a visual representation of 'Standard Installations - Quick Coupling'.

10. For 'Changeover/Bulkhead Installations - Quick Coupling': connect the high-pressure hose to the GasStop Adapter and tighten until gas tight. Now connect the hose to the change-over/bulkhead device. Do not use a GasStop Adapter in conjunction with an excess flow valve (EFV). The pressure regulator used must be rated no higher than 50 mbar and not bear the markings 'EFV'. On changeover/bulkhead installations a GasStop Adapter must be installed on each cylinder connected to the changeover/bulkhead. See diagram below (Figure 4.) for a visual representation of 'Changeover/Bulkhead Installations - Quick Coupling'.

11. Your system is now ready to prime. It is **highly recommended** that all systems are checked for leaks prior to use (see section C. below).

12. Rotate the lever to the 12 o'clock/0° position, pointing to "ON". If the lever does not easily move to the "ON" position, do not force it - your GasStop is not connected to the cylinder correctly.

13. Once the lever is in the "ON" position, switch the pressure regulator on (as per the manufacturers instructions).

14. To prime the GasStop simply pump the gauge 4-6 times. You will now notice gas flowing into the system. If the needle is stable and GasStop has not shut-off you are ready to use your appliance(s) as normal.

⚠️ Important. If the outcome is not as described in **point 14**, please stop using your gas. Contact a gas specialist before any further use.

15. At the end of any gas use, turn off the appliance(s), the pressure regulator and the GasStop. Remove the GasStop from the cylinder. To remove the GasStop make sure the lever is in the "OFF" position and press the "PUSH" button to release it from the cylinder. Disconnect the hose from your appliance in a well-ventilated area, as residual gas may still be in the system.

⚠️ Important. Residual gas! Never install or uninstall your gas system near a naked flame. **Smoking is strictly prohibited!**

⚠️ Important. Quick-coupling installations. Always remove your GasStop from the cylinder after use.

ⓘ See FAQ section below for commonly asked questions.

FIGURE 3. STANDARD INSTALLATIONS - QUICK COUPLING

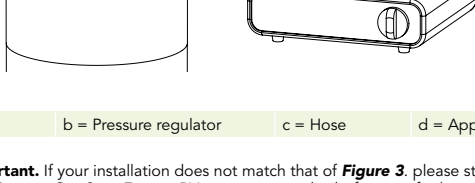

a = GasStop b = Pressure regulator c = Hose d = Appliance

⚠️ Important. If your installation does not match that of **Figure 3**, please stop using your gas. Contact Gas Stop Europe BV or a gas specialist before any further use.

FIGURE 4. CHANGEOVER/BULKHEAD INSTALLATIONS - QUICK COUPLING

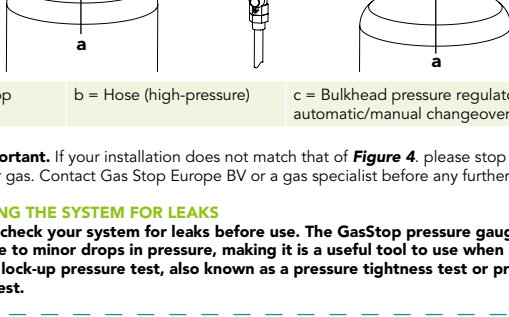

a = GasStop b = Hose (high-pressure) c = Bulkhead pressure regulator or automatic/manual changeover device

⚠️ Important. If your installation does not match that of **Figure 4**, please stop using your gas. Contact Gas Stop Europe BV or a gas specialist before any further use.

C. CHECKING THE SYSTEM FOR LEAKS

ⓘ Always check your system for leaks before use. The GasStop pressure gauge is sensitive to minor drops in pressure, making it a useful tool to use when performing a visual lock-up pressure test, also known as a pressure tightness test or pressure decay test.

ⓘ This test can only be carried out prior to normal gas usage. During normal gas usage, GasStop will not shut-off the system in the event of a minor leak.

ⓘ During normal gas usage, GasStop will only shut-off the system in the event of a major leak.

⚠️ Important. Residual gas! Never test your gas system near a naked flame. **Smoking is strictly prohibited!**

To test your system for leaks:

1. Set up your system as described in section B.1. or B.2. Turn off the tap on the gas cylinder (B.1) or on your GasStop (B.2). Now turn off your gas appliance(s).
2. Now turn the gas cylinder back on (B.1.) or the GasStop and pressure regulator back on (B.2.). Keep all appliances off for the time being.
3. Pump the pressure gauge on the GasStop up and down steadily at least 4 to 6 times. The longer the distance the gas has to travel in the pipe or hose, the more you will need to pump. If insufficient pressure has been created, the GasStop will keep shutting-off the gas supply. Double check at this point that your appliance is still switched off.
4. The needle on the gauge should now indicate the gas pressure. If the needle is on zero, or below the red bar on the gauge, then the cylinder tap/valve is not open, GasStop has shut-off, the gas has run out or you have not carried out sufficient pumping. Is the temperature around freezing? Please refer to the Useful Tips section.
5. Now turn off the tap on the gas cylinder (B.1) or on the GasStop (B.2.) and register the exact position of the needle on the gauge. Wait 60 seconds for Standard Installations and 5 minutes for longer gas systems (e.g. caravans, motorhomes, boats and houses).

6. At this point, pressurised gas is now held between the GasStop and your appliance(s).

7. If the needle has dropped from its initial registered position at the end of the recommended period of waiting time, there is a leak (pressure decay). Do not use the gas system until the leak has been solved or repaired by an approved gas specialist.

8. If, after pumping, the needle remains in the same position during the waiting time specified above, you can carefully start using the system as described in section B.1. or B.2.

SAFETY REMINDER:

⚠️ Never install, uninstall or test your gas system near a naked flame.

⚠️ Smoking is strictly prohibited!

⚠️ Always check the system for leaks prior to use (section C.).

⚠️ If you are ever in doubt, contact an approved gas specialist immediately for advice.

⚠️ Do not use GasStop in conjunction with an excess flow valve (EFV).

⚠️ GasStop is not designed to shut-off in the event of a minor leak. GasStop is designed to shut-off in the event of a major leak only.

⚠️ Always make sure your GasStop unit corresponds with the recommended gas cylinder, pressure regulator, installation and gas type. Never force a GasStop to fit. If in doubt, contact an approved gas specialist immediately.

⚠️ Important. If you suspect your GasStop may be damaged or faulty, do not use the device and contact Gas Stop Europe BV or an approved gas specialist immediately.

D. READING THE GAS PRESSURE GAUGE

ⓘ The gas pressure gauge is not a precise tool for measuring gas cylinder contents. It does however have many useful functions.

• The gauge indicates when the gas cylinder is almost empty (a decline in the vapour pressure curve). The gauge does not indicate the exact amount of LPG left in the cylinder.

• A steady pressure reading only indicates that LPG is left in the cylinder.

• If the needle is pointing to:

HIGH: Increased gas pressure

GAS: Sufficient gas (steady pressure)

LOW: Almost empty (approximately 30 minutes left of gas use)

• Use the gas for at least ten minutes before checking the gas pressure level.

• Check the gauge before turning off your appliance(s) to assess if a refill is needed prior to next use.

ⓘ OTHER USEFUL FUNCTIONS OF THE PRESSURE GAUGE:

• Visual evidence of pressure decay (a minor leak) to activate the lock-up pressure test scenario (see section C.)

• Visual evidence of high pressure

• Visual evidence of a shut-off

• Visual evidence of an activated and stable system

• Visual evidence of variable/unstable pressure

E. AUTOMATIC SHUT-OFF MECHANISM

ⓘ The GasStop automatic shut-off mechanism has limitations.

• GasStop will shut-off the supply of gas in the event of a major leak ($\geq 110\% \dot{m}$). The mechanical shut-off seal is 100% and can only be reset by the user - once the problem has been solved.

• GasStop will not shut-off the system in the event of a minor leak ($< 110\% \dot{m}$), if the flame/burner goes out or if the leak is not big enough to activate the GasStop.

• GasStop may shut-off the supply of gas in the following scenarios: at low temperatures (see Useful Tips), if the GasStop is not installed as prescribed, if the gas appliance is on during installation, if the gas level is low, or if the consumption of the gas exceeds the recommended capacity (refer to 'Guaranteed Capacity' on the Technical Data table).

• GasStop will automatically shut-off at $\geq 110\%$ of the guaranteed capacity (see 'Valve Shut-Off' on the Technical Data table at the top of these instructions for reference).

F. FAQ

• Make sure that any unburnt or residual gas can always be extracted safely via appropriate ventilation. Make sure that any ventilation remains uncovered. Never ventilate or disconnect your system near a naked flame (minimum distance: 10 metre radius).

• To prevent premature weathering of the GasStop, do not leave the device exposed to variable weather conditions for a prolonged period of time.

• GasStop may shut-off the gas supply if the temperature drops to around freezing. In such cases, try to restore the gas flow by pumping the device 4 to 6 times.

• If you are using butane gas at low temperatures, GasStop will shut-off the gas supply. At temperatures around freezing, butane gas remains liquid rather than changing into a gaseous form. The pressure gauge on the GasStop may then indicate 'LOW' when the gas bottle is not empty.

• In humid, cool or changeable weather conditions, condensation may appear on the inside surface of the transparent gauge face. This happens as the air trapped inside the gauge condenses, forming small surface water droplets on the plastic casing. Although this is not common, it will not affect the operation of the GasStop. To rectify the problem, remove your GasStop from the gas system and leave the product in a dry and ambient location. After a while the condensed water will evaporate and the visual appearance of the gauge will return to normal.

⚠️ Important. If you suspect your GasStop may be damaged or faulty, do not use the device and contact Gas Stop Europe BV or an approved gas specialist immediately.

G. USEFUL TIPS

OTHER USEFUL FUNCTIONS OF THE PRESSURE GAUGE:

GasStop will only shut-off in the event of a major leak. A major leak is defined as a sudden and dramatic change in the gas flow rate ($\geq 110\% \dot{m}$). GasStop will not shut-off the supply of gas in the event of a minor leak ($< 110\% \dot{m}$).

If GasStop was calibrated to shut-off in the event of a minor leak, this would interfere with the 'normal' usage/consumption of your gas appliance(s) - GasStop would shut-off every time you use your appliance(s). We have therefore calibrated the device to shut-off for major leaks only ($\geq 110\% \dot{m}$).

CAN GASSTOP BE USED ON A BULKHEAD OR AUTOMATIC/MANUAL CHANGE OVER GAS PRESSURE REGULATOR?

Yes. GasStop can be used on a bulkhead or an automatic/manual changeover gas pressure regulator, regulated to a pressure of no higher than 50 mbar. A GasStop will need to be installed on each cylinder attached to the bulkhead/changeover device.

CAN GASSTOP BE USED WITH A CRASH SENSOR VALVE?

Yes. GasStop can be used alongside a crash sensor valve, regulated to a pressure of no higher than 50 mbar.

CAN A GASSTOP BE USED WITH AN OPSO OR UPSO VALVE?

Yes, GasStop can be used in conjunction with either an OPSO or an UPSO valve without interference.

IS GASSTOP RATED FOR MARINE USE?

GasStop is not rated for marine use (useful in salt water conditions where ammonia exposure may be present). Please contact a marine gas specialist for further information on marine gas installations.

WHY DOES GASSTOP KEEP SHUTTING-OFF WHEN I TRY TO USE GAS?

If installed correctly GasStop will only shut-off if there is a major problem with your system e.g. a major leak or catastrophic pressure regulator failure. If no major leak is present it may be that an inappropriate appliance or pressure regulator is being used. If you are ever in doubt, contact a gas specialist before using your gas.

H. CONTACT

For further information, or if you have any questions, please visit our website for more details. Alternatively please contact our support team directly.

info@gasstopglobal.com | www.gasstopglobal.com

I. MANUFACTURER'S WARRANTY (EU ONLY)

Gas Stop Europe BV warrants your GasStop to be free from construction and material defects. This warranty is provided to the first Purchaser, purchasing the product for consumer use, valid for five (5) years from the date of purchase. The warranty covers replacement of the GasStop if it is defective. The warranty does not cover defects due to improper use or installation of the product. If a defect arises during the warranty period and the Purchaser wants a replacement product, then the Purchaser is to send a clear description and photograph of the defect in question, along with a copy of the original proof of purchase to Gas Stop Europe BV. If the warranty claim is recognised by Gas Stop Europe BV, then the transport expenses shall be borne by Gas Stop Europe BV. If no warranty claim is applicable, the Purchaser will be notified accordingly and any repair and transport expenses shall then become the Purchaser's liability.

Our goods are supplied with warranties which cannot be excluded pursuant to European and national consumer legislation. In the case of a major defect, you are entitled to a replacement or a refund and to compensation for any other reasonable costs due to loss or damage.

You are entitled to have goods repaired or replaced if they are not of acceptable quality and the defect is not serious. The purchaser benefits from this warranty in addition to his/her other rights pursuant to legislation relating to goods or services which are covered by the warranty.

The Manufacturer disclaims liability for any damage or injuries as a result of the following:

- Not using the device as is intended
- Installation of non-original spare parts
- Unauthorised modification without written approval by the manufacturer
- Use of unauthorised equipment
- Ignoring important information listed in these instructions

MAKING A WARRANTY CLAIM (EU ONLY)

ⓘ Before returning your defective product, please ensure that you have proof of purchase and that your item was bought from one of our authorised resellers (please refer to our website for a full list of authorised resellers). Prior to claiming, please also provide Gas Stop Europe BV with the following:

- Detailed description and photograph of the defect
- Serial number of the unit (the serial number is clearly marked on all devices)

Once you have all of the relevant documentation and are confident your defective product is covered by our warranty, you can contact our support team online. Our team will advise you further on how to proceed. To avoid transport damage, the affected unit must only be shipped by prior arrangement. We ask you not to send the unit without prior arrangement.

COMPANY INFORMATION

Gas Stop Europe BV | KvK: 65511034 | RSIN: NL856141690

Ceresplein 70, 9401 ZG Assen, Netherlands. **info@gasstopglobal.com**

COPYRIGHT

GasStop, 'GasStop', 'GASSTOP', and 'Gas-Stop' are trademarks of Gas Stop Europe BV. All GasStop products are protected registered designs.